

## ASSEMBLY INSTRUCTIONS

### Jada Wall Sconce

---

LIGHTING

## CAUTION

**BEFORE INSTALLING FIXTURE, MAKE SURE THE POWER TO THE CIRCUIT IS TURNED OFF AT THE MAIN FUSE BOX / CIRCUIT BREAKER UTILITY BOX.**

## IMPORTANT SAFETY INSTRUCTIONS

- These instructions are provided for your safety. It is very important that they are read carefully and completely before beginning the installation of this lighting fixture.
- We strongly recommend that a professional electrician install all direct wire fixtures.
- THIS PRODUCT MUST BE INSTALLED IN ACCORDANCE WITH THE APPLICABLE INSTALLATION CODES BY A PERSON FAMILIAR WITH THE CONSTRUCTION AND OPERATION OF THE PRODUCT AND THE HAZARDS INVOLVED.
- The lighting fixture is meant for indoor use. It must be connected only to 3 wire, single phase electrical supply systems (provided with Ground wire or equivalent protection).
- For your safety, it is strongly recommended that two people install the lighting fixture.
- To avoid the risk of fire, do not exceed the recommended lamp wattage.
- The lighting fixture is meant for indoor use, DRY LOCATIONS ONLY.
- Save these instructions.

## WARNING

- **To reduce the risk of fire, electrical shock or personal injury, always turn off light fixture and allow it to cool prior to replacing light bulb.**
- **Do not touch bulb when fixture is turned on. Do not look directly at lit bulb.**
- **Keep flammable materials away from lit bulb.**
- **This lighting fixture contains lead, a chemical known to the State of California to cause cancer, birth defects and other reproductive harm. Wash hands after installing, handling, cleaning or otherwise touching this light fixture.**

## PRE-ASSEMBLY INSTRUCTIONS

Remove all parts and hardware from box along with any plastic protective packaging.

Do not discard any contents until after assembly is complete to avoid accidentally discarding small parts or hardware.

For your safety and convenience, assembly by two people is recommended.

PRE-ASSEMBLY INSTRUCTIONS CONTINUED

PARTS INVENTORY		
ID	DESCRIPTION	QTY
A	WIRE CONNECTOR	2
B	CANOPY SCREW	1
C	MOUNTING SCREW	2
D	MOUNTING PLATE	1
D	BULB	1

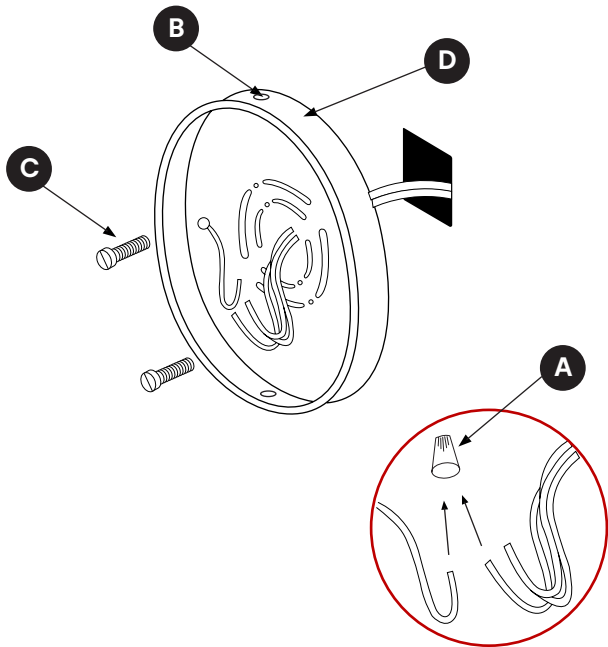
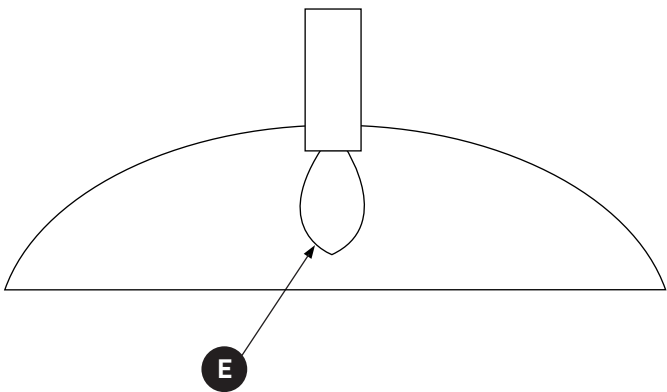

## ASSEMBLY INSTRUCTIONS

1. Turn OFF power to the Outlet box where the wall light will be installed.
2. Remove the **MOUNTING PLATE (D)** from the Sconce by unscrewing **CANOPY SCREW (B)**.
3. Attach mounting plate to wall or junction box using **MOUNTING SCREWS (C)**.
4. Connect ground wire from wall to ground wire from sconce using **WIRE CONNECTOR (A)**.
5. Attach house wire to sconce wires as shown. Fasten the pairs together with a **WIRE CONNECTORS (A)**. **DO NOT REVERSE THE HOT AND NEUTRAL CONNECTION OR SAFETY WILL BE COMPROMISED.**
6. Attach front face of light to back plate by inserting **CANOPY SCREW (B)** through predrilled hole in front face and into back plate as shown. Tighten using screwdriver.
7. Insert (1) E12 6W BULB into the socket.

## CARE INSTRUCTIONS

- Wipe clean with a soft, dry cloth or static duster.
- Always avoid the use of harsh chemicals or abrasive cleaners as they may cause damage to the fixture's finish.